

STREET LIGHT SERIES

XLD-L010C

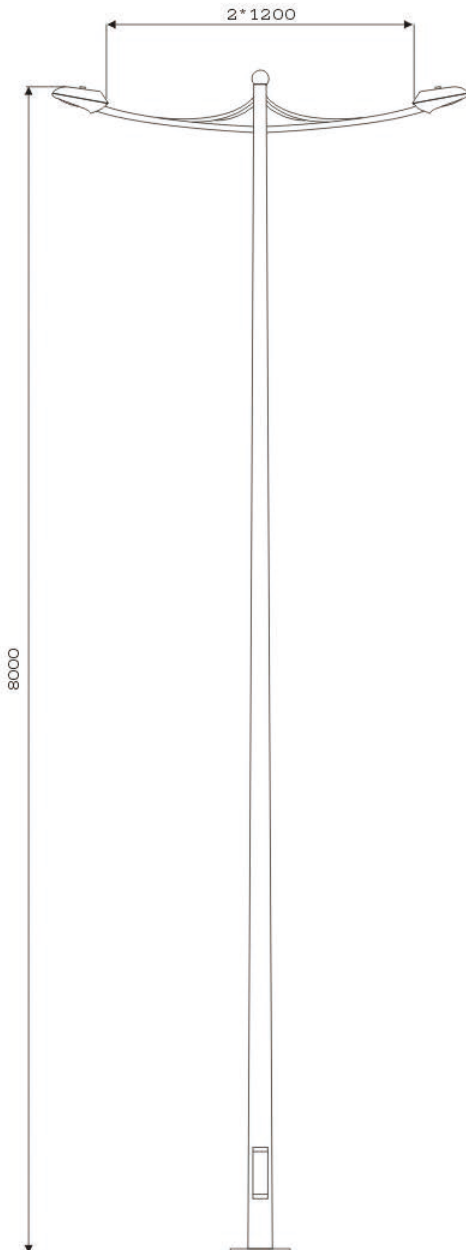

Structural characteristic

1. High pressure die casting aluminium body featuring high strength and anti-corrosion
2. Streamlined structure with smaller EPA and lighter weight
3. Side entry and top Mount
4. High degree pure aluminum optimized reflector provide wider application
5. Attachable control gear mounting plate, plug in-out connection.

Technical Parameters

1. IP rating:
Control gear compartment: IP65
Optical compartment: IP66
2. Anti-corrosion property: classII
3. Ambience Temp: -35°C~ +45°C
4. Electric shock resistance: classI
5. Socket: E27 E40
6. Power: 220V(±10%)/50Hz
7. Light source: 70W-250W HPS/MHL lamp

Dimensions(mm)

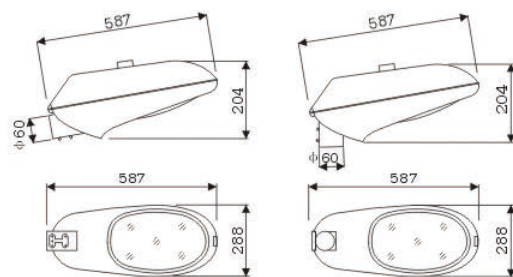

Photometric Data

Light Distribution Curve C0/C180

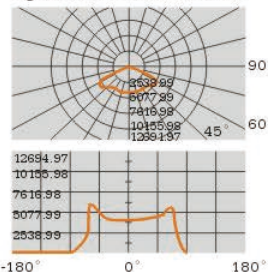

Light Distribution Curve C90/C270

